

# Disc Bottom Outlet Valves - Metal Bellows Seal to Atmosphere

## Features

## Type 25BH

SchuF Type 25BH metal-bellows-sealed flush-mounted bottom-outlet valves see extensive service in the bulk pharmaceutical and fine chemical industries. They are often used in the production of core active-ingredient acids and vitamins.

These valves utilise an expanding bellows to provide an impermeable, friction-free seal as the spindle/stem strokes open and closed, eliminating the possibility of fugitive emission from that area. Available in Stainless Steel, Hastelloy (or other alloy) body and trim, these valves provide a solution where customers require a flush-mounted, custom-fit valve with high corrosion resistance and complete operational reliability in order to maximise their system's high-level functionality.

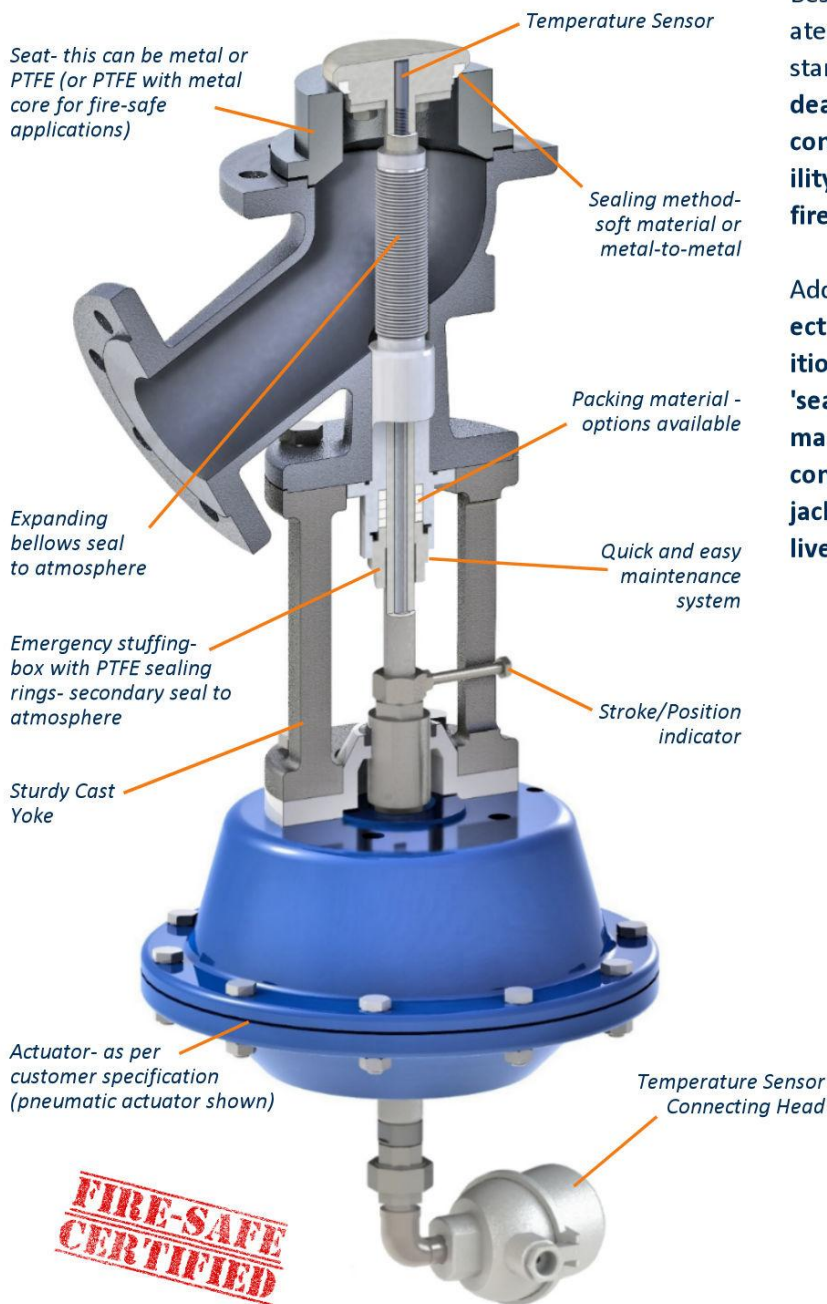

Bespoke design requirements can be incorporated into each valve alongside tried and tested standard design features, such as **elimination of dead-space** in the vessel outlet, **FDA and GMP compliance for disc valves**, **full cleaning capability** together with being **flushable in place** and **fire-safe certified**.

Additional options include **flushing/purging connections**, **internal and external polishing**, **positioners**, **limit switches**, **solenoid valve(s)**, **'seat-less' disc valve construction**, **CIP / GMP**, **manual over-ride actuator**, **'T'- or spool-piece connection**, **leak detection**, **disc-grinding**, **jacking bolts**, **disc contouring**, **tapered seats**, **live-loaded packing** and **spindle wipers**.

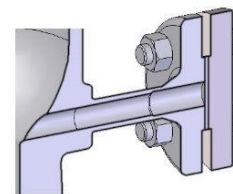

CIP (Clean In Place) option- flanged connection shown



Manual Override for pneumatic actuator